

Thank you for using NABELL Robot-Flex. The below will help guide you in installing the cover properly.

Installation Precautions

- The images of the products shown are for reference only. Your model may vary slightly
- Remove any peripheral devices before installing the cover to minimize any risk of damage.
- Verify the robot is at rest and powered off before installing your Robot-Flex cover.
- Installation and removal should be performed slowly and carefully.
- Excessive force may cause damage to the robot, cover and/or cause personal injury.
- After installing the cover, check for gaps at the joined areas. Adjust, if necessary.
- Manually move robot, about all axis of rotation to insure smooth movement, before powering on

1. Components

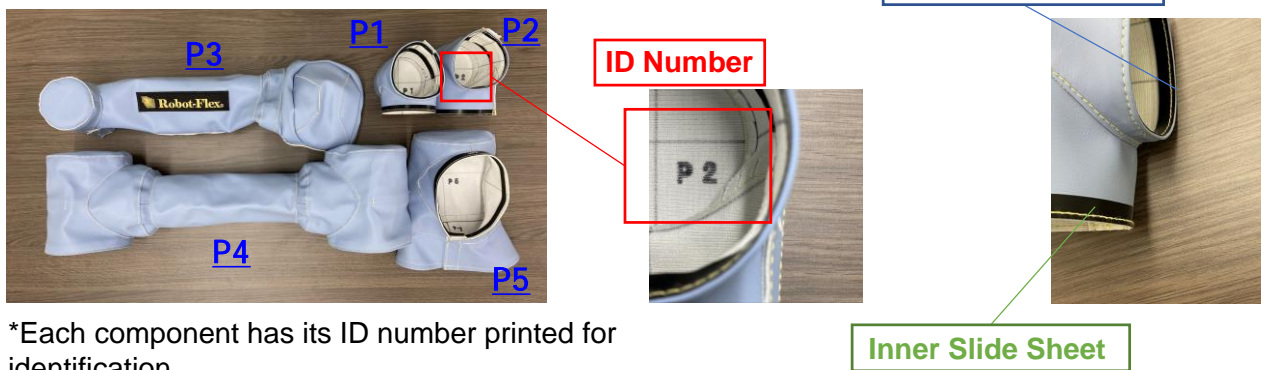

*Each component has its ID number printed for identification.

2. How to mount

① Posture of Robot

- Position the robot and each of its arms where it is convenient to work with.
- Each component (P1~P5) to be applied shown as in the picture.

〈Component mounting order〉

- **P1→P2→P3→P5→P4 (P4 comes to the last)**

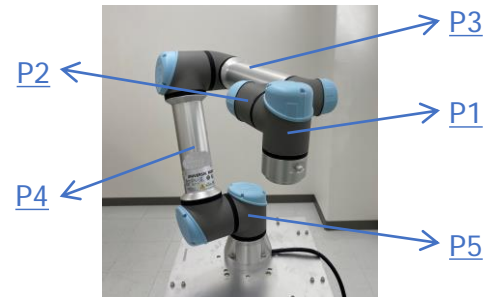

② Mounting of [P1] (First)

- Detach Velcro and mount the cover. Then fasten Velcro tightly.
- Make sure the outer sliding sheet is lined up straight. (*1) (Do the same for all others)

(*1)

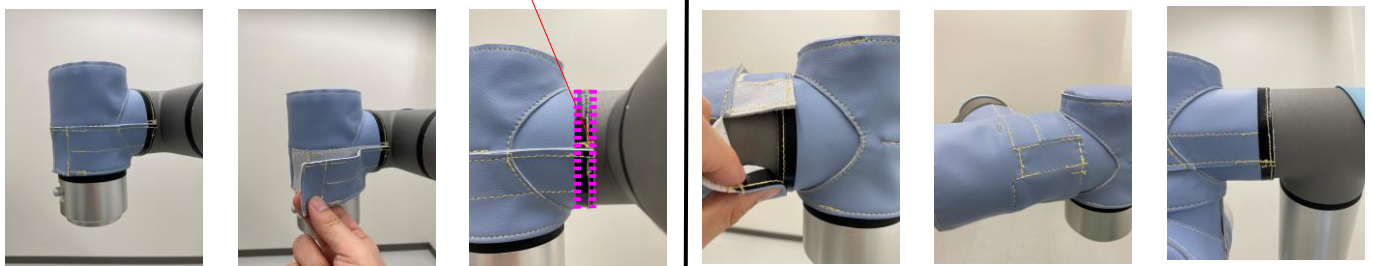

③ Mounting of [P2]

- Same procedure as P1.
- Make sure its inner sliding sheet is located over outer sliding sheet of P1.

④ Mounting of [P3]

- The inner sliding sheet of P3 needs to be over the outer sliding sheet of P2.
- The rubber of outer slide sheet side needs to mount in the correct position. (*2)
(Mounting to error position, can cause corruption)

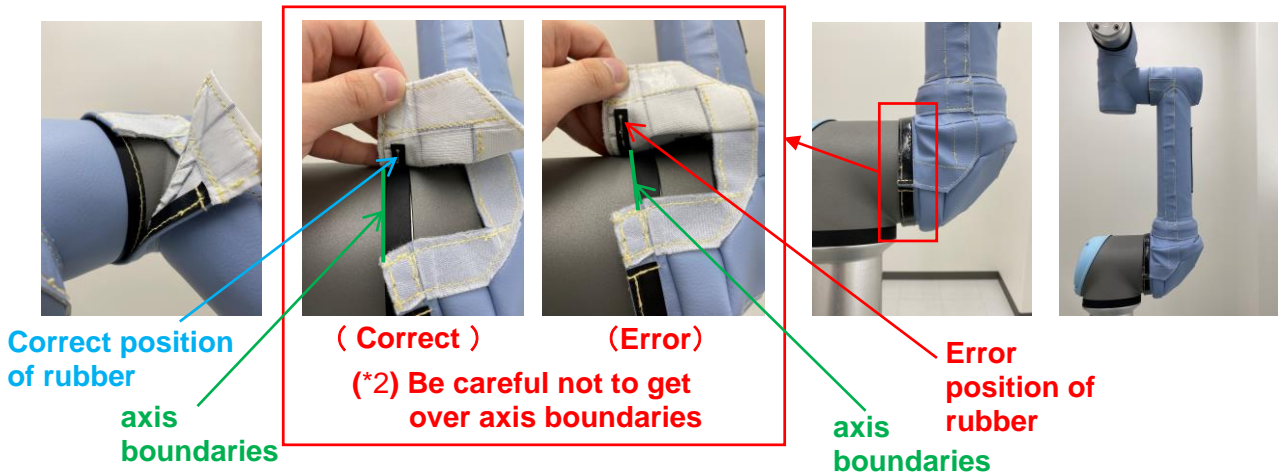

⑤ Mounting of [P5]

- Detach Velcro and mount the cover. Then fasten Velcro tightly.



⑥ Mounting of [P4]

- Detach Velcro and mount the cover. Then fasten Velcro tightly.
- Mount to locate the inner sliding sheet to meet over the outer sliding sheets of P3 and P5.
- At this time, the marking "P4" needs to be on the side of P3. (Not the bottom of the robot.)
- Mounting complete

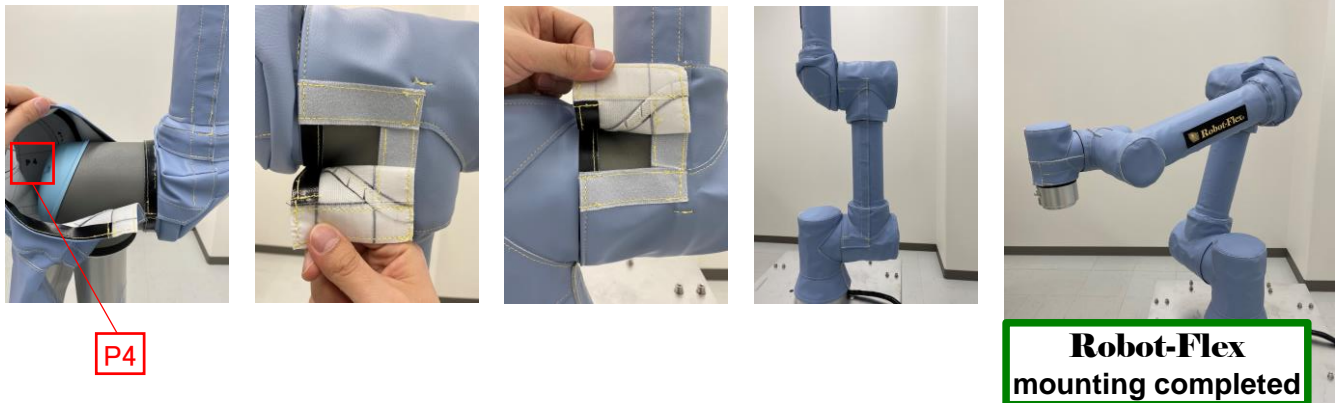

Contact Information

 株式会社 ナベル
NABELL CORPORATION
<https://www.bellows.co.jp>
 E-mail:nabell@bellows.co.jp

Headquarters
 7-2-3 Yumegaoka, Iga, Mie, 518-0873
 TEL: +81-595-21-5060
NABELL USA CORPORATION
 208 Charter St Albemarle, NC 28001 U.S.A
 TEL:+1-704-986-2455